

### INSTALLATION OF BATTERY (STEP 1)

S/N	DESCRIPTION	QUANTITY	SPECIFICATION	REMARK
①	Sealed strip	1		In battery box
②	Electrolyte	1		In battery box
③	Battery	1		In battery box
④	Wire, earth	1	Black	On motorcycle
⑤	Footrest carpet	1		On motorcycle
⑥	Bolt	2	M6X12	In battery box
⑦	Gasket	2	∅ 6	In battery box
⑧	Washer	2	M6	In battery box
⑨	Body	1		
⑩	Wire, motor	1	Red	On motorcycle
⑪	Wire, power	1	Red	On motorcycle
⑫	Battery cover	1		On motorcycle
⑬	Bolt	2	ST4.8X16	On motorcycle

#### INSTALL STEP:

- 1, Fill ② into ③ refer to the instruction of battery, close down the battery with ①.
  - 2, Take down ⑤ from ⑨, take down ⑫ from ⑨ by loose ⑬.
  - 3, Connect ⑩ and ⑪ on the anode of ③ with ⑥, ⑦ and ⑧, connect ④ on the cathode of ③ With ⑥, ⑦ and ⑧.
- ATTENTION: ⑦ must be put above on the anode and cathode, ⑧ must put inside the anode and cathode.
- 4, Put ③ into ⑨'s slot.
  - 5, Replace ⑫ with ⑬.
  - 6, Replace ⑤.
- You should wait for about 30 minutes after fill the electrolyte, then the battery can be put into use.

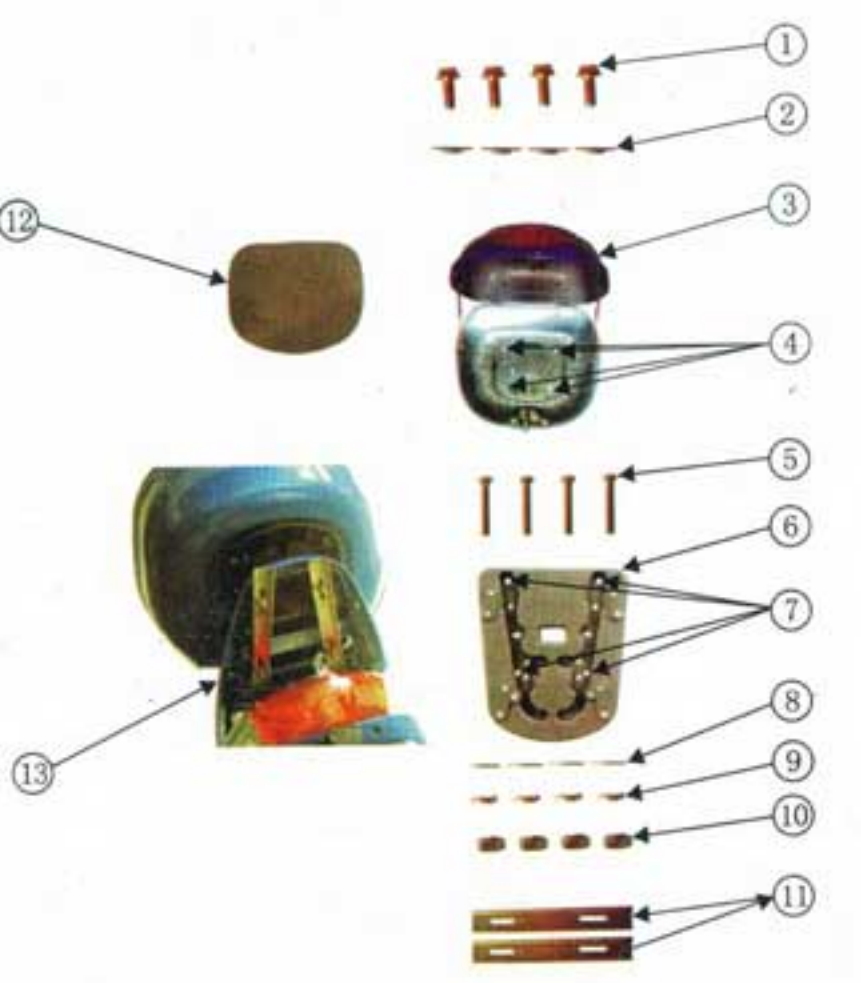

### INSTALLATION OF REAR BOX (STEP 2)

S/N	DESCRIPTION	QUANTITY	SPECIFICATION	REMARK
①	Bolt	4	M6X20	In ③
②	Gasket	4	∅ 6	In ③
③	Rear box	1		On motorcycle
④	Fixing hole	4		On ③
⑤	Bolt	4	M6X45	In ③
⑥	Soleplate	1		In ③
⑦	Fixing hole	4		On ⑦
⑧	Washer	4	∅ 6	In ③
⑨	Washer	4	∅ 6	In ③
⑩	Screw	4	M6	In ③
⑪	Holder	2	213mm	In ③
⑫	Sponge cushion	1		In ③
⑬	RR, frame	1		On motorcycle

#### INSTALL STEP:

- 1, Put ⑥ on ⑬, put ⑪ under ⑬, and fix ⑥, ⑬, ⑪ together with ⑤, ⑧, ⑨ and ⑩. make sure ⑧, ⑨ and ⑩ under ⑪ orderly.
- ATTENTION: ⑤ should penetrate ⑥, ⑬, ⑪ from the first and third slot of ⑬, referring ⑫
- 2, Put ② on ④, fix ③ on ⑥ by ①, ②, ④ and ⑦.
- 3, Put ⑫ into ③.



### INSTALLATION OF REAR VIEW MIRROR (STEP 3)

S/N	Description	Quantity	Specification	Remark
①	camp	1		In sundries box
②	Bolt	1	M8*40	In sundries box
③	Washer	2	∅ 8	In sundries box
④	L.RR.mirrior	1		In sundries box
⑤	Rubber housing	1		In sundries box
⑥	Bush	1	∅ 8.5*10	In sundries box
⑦	R.camp	1		In sundries box
⑧	Bolt	1	M8*35	In sundries box
⑨	R.RR.mirrior	1		In sundries box
⑩	Rubber housing	1		In sundries box
⑪	Bush	1	∅ 8.5*5	In sundries box
⑫	Fr.part	1		On motorcycle

#### INSTALL STEP:

Make sure the turning light switch on OFF position before install.

1. Penetrate ④'s wire through ⑤, and connect with ⑫'s wire (the same color together)
2. Penetrate ⑨'s wire through ⑩, and connect with ⑫'s wire (the same color together)
3. Check the turning light bright or not when turn on the switch.
4. make ② go through ③、④、⑤ and ⑥ orderly, then fasten it on ⑫ (before fastening, adjusting the point view of RR.view mirror)
5. make ⑧ go through ③、⑨、⑩ and ⑪ orderly, then fasten it on ⑫ (before fastening, adjusting the point view of RR.view mirror)

3

### INSTALLATION OF L.HANDLE BAR (STEP 4)

S/N	Description	Quantity	Specification	Remark
①	L, handle bar	1		In sundries box
②	Steering handle	1		On motorcycle
③	Decorative block	1		In sundries box

#### INSTALL STEP:

- 1, Install ① on ②.
- 2, Insert ③ into ②.

4

